

ORDERING INFORMATION

SERIES NO. J0616-810	PCB TYPE D	CABLE ENTRY TYPE 1	NO. OF CONTACTS XX	ME TYPE 0	PLATING TYPE XX	PACKING TYPE XX	MARK X	MYLAR X	FIRST PIN TYPE X	REMARKS X
D:DIP TYPE	1:TOP ENTRY	03~32PIN	0:WITHOUT ME	20:DULL PURE TIN OVER NICKEL	11:TUBE 31:TAP&REEL(24mmB3) 32:TAP&REEL(32mmB3) 33:TAP&REEL(44mmB3) 34:TAP&REEL(56mmB3) 51:BOX	0:NO MARK 2:OTHER MARK	N:NO MYLAR 1:5.0X3.5	N:NORMAL R:REVERSE	1:CONTACT SOLDER TAL L=2.00mm 2:CONTACT SOLDER TAL L=2.40mm	

NOTE:
MATERIAL:
HOUSING:GLASS FILLED THERMO-PLASTIC
UL 94V-0
CONTACT: PHOSPHOR BRONZE
THIS PART DON'T CONTAIN ANY SUBSTANCES WHICH ARE SPECIFIED IN SS-00259
SPECIFICATION:
CURRENT RATING: 0.5A AC/DC
VOLTAGE RATING: 50V AC/DC
CONTACT RESISTANCE: 30mΩ MAX
INSULATION RESISTANCE: 100MΩ MIN
DIELECTIC WITHSTANDING VOLTAGE: 500V AC.
TEMPERATURE : -20°C TO +85°C

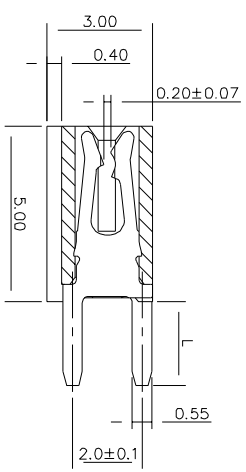
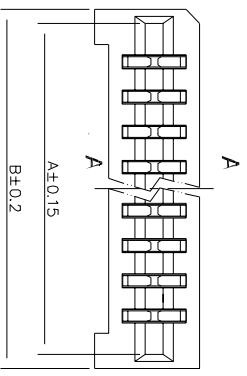
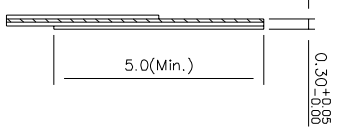
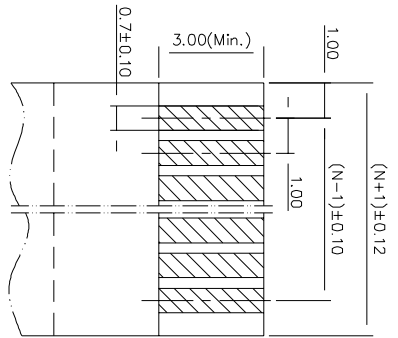
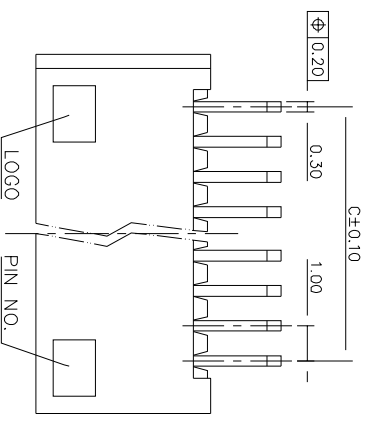

L1	2.00mm
L2	2.40mm

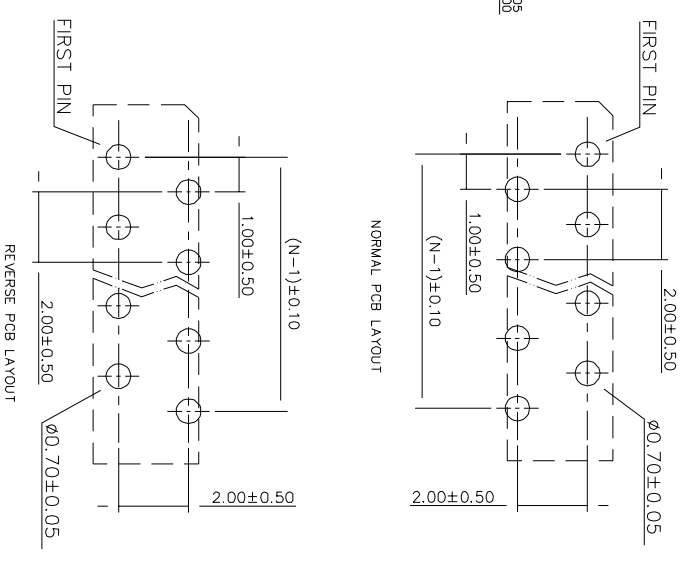

PIN NO	DIM.A	DIM.B	DIM.C
03	4.2	5.0	2.0
04	5.2	6.0	3.0
05	6.2	7.0	4.0
06	7.2	8.0	5.0
07	8.2	9.0	6.0
08	9.2	10.0	7.0
09	10.2	11.0	8.0
10	11.2	12.0	9.0
11	12.2	13.0	10.0
12	13.2	14.0	11.0
13	14.2	15.0	12.0
14	15.2	16.0	13.0
15	16.2	17.0	14.0
16	17.2	18.0	15.0
17	18.2	19.0	16.0
18	19.2	20.0	17.0
19	20.2	21.0	18.0
20	21.2	22.0	19.0
21	22.2	23.0	20.0
22	23.2	24.0	21.0
23	24.2	25.0	22.0
24	25.2	26.0	23.0
25	26.2	27.0	24.0
26	27.2	28.0	25.0
27	28.2	29.0	26.0
28	29.2	30.0	27.0
29	30.2	31.0	28.0
30	31.2	32.0	29.0
31	32.2	33.0	30.0
32	33.2	34.0	31.0

JJP Jen Jia Precision Co., LTD.

INTENDED USE CUSTOMER	TITLE	1.0mm PITCH NON-ZIF FPC/FPC DIP TYPE TOP ENTRY CONN.
TOLERANCES	PART NO.	J0616-810-D1XXXXXXX
LINEAR 0.0 ±0.30 0.00±0.20 ANGLES ±3°	DRAW NO.	J0616-810-D1XXXXXXX
	MATERIAL	SEE NOTE
	FINISH	SEE NOTE
	SCALE	1:1
	SHEET	1/1
	REV	A
	DATE	08/12/09
	UNIN	mm

APPRO	CHKD	DATE
Mtrk	Steve	08/12/09
	Ting	