

THE INFORMATION CONTAINED IN THIS DOCUMENT IS PROPRIETARY TO JEN JIA PRECISION TECHNOLOGY CO.,LTD. ANY REPRODUCTION IN PART OR WHOLE WITHOUT PRIOR WRITTEN APPROVAL OR AUTHORIZATION OF JEN JIA PRECISION TECHNOLOGY CO.,LTD IS STRICTLY PROHIBITED.

RoHS COMPLIANT

REVISIONS				
REV	ECN NO.	DESCRIPTION	APPROVED BY	DATE
A		ISSUE A	JASON MENG	2007-12-17

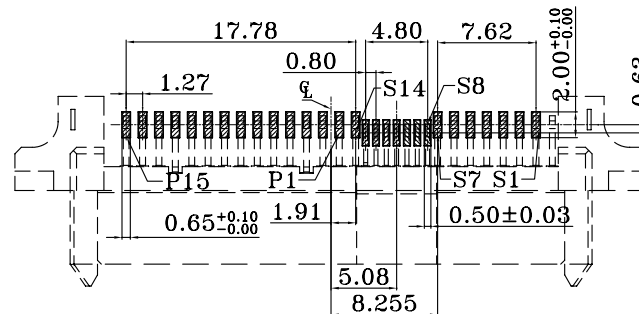
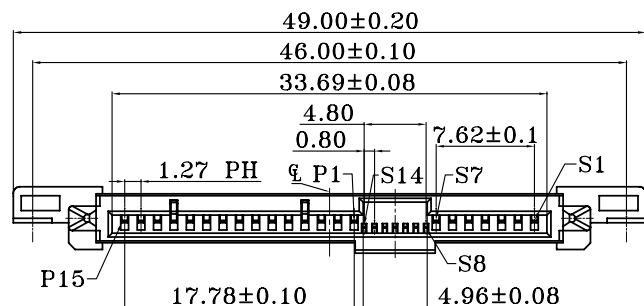

RECOMMENDED P.C.B T=1.60MM

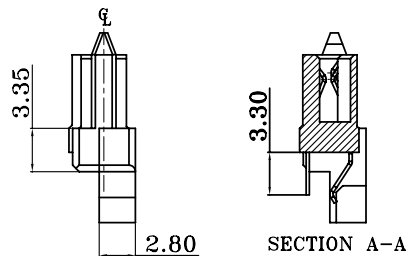
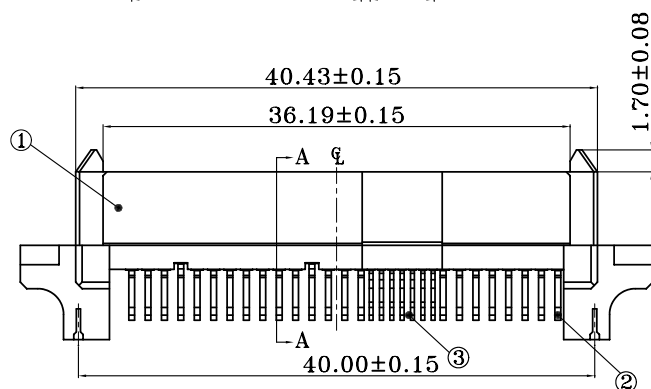

J191201-SF2 XX 021 X K A
1 2 3

1.Plating:

- 21-Flash.Gold in contact area/
100u" Min Tin in solder area.
- 22-3U" Min.Gold in contact area/
100u" Min Tin in solder area.
- 23-5U" Min.Gold in contact area/
100u" Min Tin in solder area.
- 24-10U" Min.Gold in contact area/
100u" Min Tin in solder area.
- 25-15U" Min.Gold in contact area/
100u" Min Tin in solder area.
- 26-20U" Min.Gold in contact area/
100u" Min Tin in solder area.
- 27-30U" Min.Gold in contact area/
100u" Min Tin in solder area.

2."-":RoHS "Ⓢ":GP

NO.	DESCRIPTION	MATERIAL	COLOR	REMARK
3	Terminal	Pho.Bronze C5191R-H		Gold/Tin Plated
2	Terminal	Pho.Bronze C5191R-H		Gold/Tin Plated
1	Housing	L.C.P	Black	UL 94V-0

DIMENSIONS:
 MM [INCH] INCH [MM] MM ONLY

UNLESS OTHERWISE SPECIFIED,
GENERAL TOLERANCE:
 DECIMALS ANGLES
 X. ±0.38 [0.015] X° ±3°
 .X ±0.25 [0.010] .X° ±1.0°
 .XX ±0.13 [0.005]

CAD GENERATED DRAWING,
DO NOT MANUALLY UPDATE

THIRD ANGLE PROJECTION

JJP Jen Jia Precision Technology Co., Ltd.

TITLE			
SAS 29P 母座 夹板式			
PART NO.	J191201-SF2XX021XKA	APPROVED BY	JASON MENG
DRAWING NO.	J191201-SF2XX021XKA	CHECKED BY	STEVEN LIU
MATERIAL		DRAWN BY	John HE
FINISH		GENERATD DATE	2007-12-17
SCALE	SHEET	REV.	SIZE: A4
FREE	1/1	A	FILE NO.:JJP-A-05-003

DO NOT SCALE DRAWING